

K A P A



# Kollektor

VOLUME I  
NUMBER IV

FOURTH QUARTER  
1993



Ho Ho Ho

## KOLLEKTOR KOMMENTS

by Lou Buffardi

The above Holiday Greeting Card photo and enclosed plan for the Megow Pfalz D-III are courtesy of Walt Winicki. The centerfold plan for the Megow Skyrocket is my present to all of you. Happy Holidays! Beware of the scale of the printwood patterns at the bottom as I reduced it to fit and it may not be in the same scale as the plan. Scale it all up or down as you wish, but have fun! Charles F. Schultz, 910 Broadfields Dr., Louisville, KY. 40207 presented us with the enclosed ad, and with the news of his new Plans + series you will love! This series includes many of the Earl Stahl plans with copies of the original articles as well as patterns laid out for you to copy. Send him a SASE for a copy of his new list--you won't be sorry. Charles also has provided an article on transferring patterns to wood. Look for it in one of our forthcoming issues. I have several of his plans and they are exquisite! Have you ever heard of the United Model Airplane and Supply Co., Irvington, N.J.? Well, Charles has a plan from them for the Curtiss A-8 of just over 15" ws that is typical 1930's. And his re-done Stahl Skyfarer is superb--and with printwood patterns to boot! Flightmasters Scale News & Views, c/o Byron Calomiris, 3406 Fela Ave, Long Beach, CA. 90808, featured a sharp 3-view of the Stinson Pursuit Trainer by Bill Winter from the Flying Aces Magazine in 1936 in their Sep/Oct 1993 issue, among other plans. I had never seen this aircraft before--very sharp!! As I left R/C long ago, I seldom read R/C articles, but Bob Aberle's column in the December Flying Models mentioned a repro copy of the Scientific Model Airplane Co. 1941 catalog, 41-pp with color repro cover for \$6.00 plus 75¢ postage from Bob Peru of Balsa Products Engineering, 122 Jansen Ave., Iselin, N.J. 08830-2601. I sent a check for one but haven't received my copy yet. Nice to see something like this become available. (I'm still looking for a Scientific 1/8A Piper Tri-Pacer). KAPA member Mike Sullivan suggested that members who have original catalogs submit a page now and then for everyone to enjoy. Great idea, Mike. So if any of you would care to send me photocopies of your catalog pages when you can, I'll run them for you. Which brings me to the question of format. If you like the current 12-page folded format, do nothing. If you want a different format or more pages, send me a postcard telling me that. With over 328 members, I will need 165 cards telling me to change. I'm trying to keep your costs down but will do whatever you wish--within reason. If you like the Megow plan for the solid, Jack Fike of Scale Flight Model Airplane Co., 1219 S. Washington St., Bloomington, IN. 47401 is reproducing copies of the original kits. Drop him a SASE for his list. Bob's Collector Shop (616) 463-7452 listed another page of Berkeley, Cleveland, etc for sale. Get on their mailing list. Col. Joe Dudzik, 301 Stonehaven Dr., Norman, OK. 73079 reports success in finding a copy of the printwood for the Berkeley Folkerts Racer and offers a copy to any member needing one for a SASE. Joe got his copy from a fellow member per his request for one, and you guys generously responded. He wishes to return the favor. You guys are really very kind! Finally, Bob De Rosier, 10421 Silverock Dr., Dallas, TX. 75218. wants to thank the member from area code 714 in Orange County who called about the Pacific Ace plans and gave so much wonderful information that his name and number were cut off by Bob's answering machine. Bob wants to thank you personally, so please get in touch again.

**NEW CURTISS F11C4 NAVY PURSUIT**

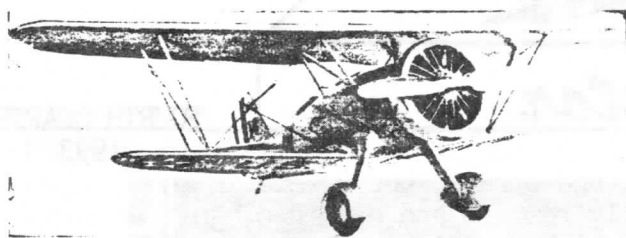

28" Span. Length 20½". Weight 4 oz. 1" Scale

THE MOST EXCLUSIVE AND FINEST EQUIPPED MODEL IN THE WORLD. A special De Luxe model, one of the most beautiful and finely detailed ever made, with its special exact scale 2½" celluloid, 1000 H.P. type, Wright Cyclone motor, having aluminum push rods, cylinder fins, etc., like real motor. Also in set are 4" aluminum cowl ring, 5" carved spruce semi-scale flying propeller, colored star and rudder insignia, 2" celluloid balloon wheels, silver dope, paint, black, red striping, Navy lettering, wire parts formed, axles, rubber motor, windshield, instrument board, flying wires, 4 aluminum -ten plates, aluminum wing walks, ready cut wheel pants, etc. All other parts printed on balsa. Detail scale drawing. Construction Set complete, postpaid..... **\$4.50**

**41" LOCKHEED ARMY SPEED VEGA**



41" Span. Length 23". Weight 8 oz. 1" Scale

This new model, built very strong yet light in weight, is practically crashproof and will out-perform any large scale model built. Rises from ground in 10 feet and flies over 650 feet. Set contains all parts printed on balsa, ready cut pant cores, 4¼" turned motor front, 11" steel type carved paulownia wood propeller, 2¼" balsa wheels, tail wheel, formed wire parts, 26' rubber, 3 oz. yellow dope, 2 oz. blue, ½ oz. black, 2 oz. glue, cement covering, full size scale drawing, and all parts. **\$4.95** Construction Set complete, postpaid. ELF 1/10 H.P. Gas Motor may be used on this Vega model.

**NEW NORTHROP A-17 ARMY ATTACK**



24" Span. Length 17". Weight 2¼ oz. ½" Scale  
Color yellow and blue

A new scale model of one of the 125 Northrops ordered for the U. S. Army. Set contains all parts printed on balsa, turned motor front, 7" carved propeller, insignia, wheels, set of colored dope, glue, and all parts. Const. set in labeled box, postpaid..... **\$2.50**

**NEW LOCKHEED ELECTRA R-20-1**



27½" Span. Length 19". ½" Scale. Color silver and red. This is an exact scale model of plane used by Amelia Earhart and transport lines.

Set has all parts printed on balsa, turned motor fronts, carved steel type props, set of 3 colored paints, glue, etc., balsa wheels, concealed motor unit through fuselage. Scale drawing. Construction Set complete, postpaid..... **\$2.95**

**NEW LOCKHEED P23A NAVY FIGHTER**

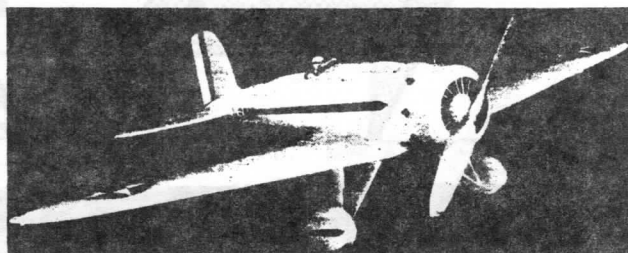

**COMBINATION LAND AND SEA PLANE SET**  
32" Span. Length 20½". Weight 3½ oz. ¾" Scale

New 4-gun Navy fighter. Model will rise from land or water in few feet. Construction set contains fuselage and pontoon formers, wing ribs, tips, etc., printed on balsa, a 2¾" turned cowl front, 2 instrument boards, colored insignia, lettering, windshields, 9" curved scale flying prop shown, 3 oz. silver paint, 1 oz. cement, ½ oz. black, 2 oz. glue, ready cut wheel pants, strong 2" aluminum wheels, 12 feet of rubber, and large 33"x44" drawing of land and sea plane. This is a sensational model and only one of its type in the world. Construction Set in labeled gift box, postpaid..... **\$2.95**  
Above model is latest improved type, just out.

**NEW BOEING F4B4 NAVY FIGHTER**

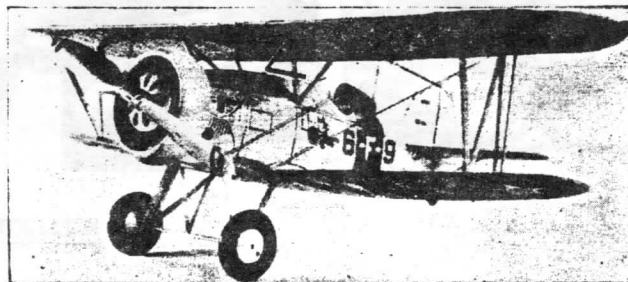

22½" Span. Length 14½". Weight 2¼ oz. Color, Grey, etc.

This is the finest equipped Boeing, F4B4 model in the world. New improved model exclusively equipped with new 3¼" special aluminum streamline tapered cowl ring, 9 cylinder celluloid motor with aluminum ventilator front, 8" carved varnished steel type propeller, printed out balsa wood parts, 2 oz. grey dope, ½ oz. yellow, ½ oz. red, paper cement, glue, formed wire parts, celluloid wheels, tail wheel, U. S. Navy lettering, colored insignia, and ¾" scale drawing. Construction Set **\$2.95** complete, postpaid

**NEW CURTISS Y1A-18 ARMY ATTACK**

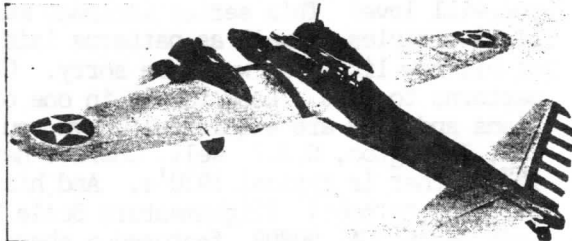

38" Span. Length 26". Color yellow and blue

This new twin motor model has lots of reserve power on its two 8" props and flies very well. Set as all parts printed on balsa, colored paints, glue, etc., full size scale drawing, two 3" turned bal-a motor fronts, wheels, two 8" steel type carved props, etc. Const. set, postpaid..... **\$4.50**

**Brown Jr. 1/5 H.P.**

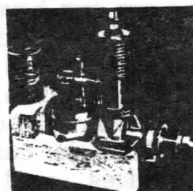

Long life motor with steel cylinder and piston for models of 5 to 8-foot span. ¾" bore, 1" stroke. Complete as shown in illustration, ready to run. **\$21.50** Price.....

**LOCKHEED VEGA GAS MODEL**

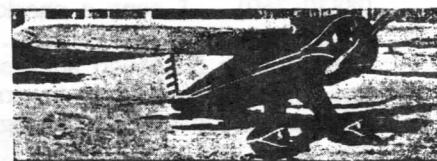

82" Span. Weight with motor 5 lbs.

Set contains formers, ribs, tips, pants, etc., all ready cut to shape, 3¾" turned motor front, 4½" rubber tired air wheels, silk covering, glue, and full sized drawing. This is a dry set without liquids. **\$17.50** Price set, f.o.b. N.Y.....

PRICES ON ALL OUR MODELS READY TO FLY SHOWN IN CATALOG.

**NEW 1938 CATALOG No. 4—16 PAGES 7½" x 9½"**

Catalog contains 6" photos of the finest models you have ever seen. Two cover etchings suitable for framing.

SEND 10c COIN

Note: Orders sent West of Miss. or Foreign, add 20c postage

California Dealer: JAYS MODEL AIRCRAFT, 7763 Melrose Ave., Hollywood, California

**MINIATURE AIRCRAFT CORP., 83 Low Terrace, New Brighton, New York**

MODEL KIT BOXES (PT 2)

by Walt Grigg

Kit condition. Grading is for box and contents. Plan replacement must be stated.

MINT- A misnomer, consistently misused for anything collectible. Correct ONLY ON COINS!!!

NEW- An article shipped from the manufacturer to a retail outlet. Once it is purchased by the consumer, and removed from the premises, it is no longer NEW. If left in the shrink wrap, and unopened, it becomes, AS NEW (guillow, and others, began this in the Sixties).

EXCELLENT- Kit has been opened, contents carefully removed and examined, just as carefully replaced. Box is not squashed, soiled, bent, or picked. (Picked is where a sharp edge has slightly broken, and raised up a bit of the cardboard).

VERY GOOD- Box has been opened a number of times, has a couple picks, small dents, but still very crisp and neat. Kit is complete and original.

GOOD- Has been opened many times, end flaps have some wear, box has some wear and picks, perhaps a bit of fading, some slight soiling, easily repairable, maybe a wheel or thrust-button missing, or end flap glued back in place, otherwise, original. No scotch, or masking tape used to repair. The vast majority of kits fall into this category.

FAIR- Has been neglected. Some parts cut out but still there, box mashed, bent, torn. If the irreplaceables (printwood, plans, box, perhaps the insignia sheet) are there, the kit is restorable. Lots of work, but if you want the kit....

POOR- Box and plans brittle. All you can do is leave it alone, or cannibalize for printwood, wheels, and such. Better than nothing.

The above is not carved in stone, since some kits will fall in between. And, regardless of experience, many times after mailing, I will wonder, if indeed I graded correctly. The best of us can miss, or overlook, or take for granted, the contents of a kit. KAPA members have return privileges, and you should always get the same with every kit purchased through the mail. I have ordered-"It's got lots of sticks, balsa and stuff...no plan...I don't know if it is all there or not"...and received someone's junk box...which is fine, if it was cheap enough. I do love junk boxes!! They are great fun to paw through!! MODEL ARCHAEOLOGY!! Finding the bones of old kits!! Why did the kid(?) not finish this one?? Why was this Comet ten-cent Aeronca Seaplane #A6 finished, and then crunched up?? Look at this Guillow Seversky..partially covered with silver tissue! Here is a Megow knife... Boy!! A dried out glube of tue! (One of us did say that...still brings a grin to think of it...)

A bit about myself...My kit collecting began in 1968-69. At this time, there are more than 700 kits in my collection, ranging from 1932 into War Two. Most are rubber scale, and solid, with only a couple of pre-war gas scale jobs. My wants are from the period 1930 through 1942. I already have nearly everything desired from the War Two period... so, normally, I will only trade pre-war kits for other pre-war kits not in my collection, or to upgrade....

Jim Alaback writes that the iron used for (ugh) Monokote, works well getting into accordion box tops, and inside the ends of the one piece boxes. I don't allow Monokote in my home.....!!! Only Japanese tissue, some silk, and a bit of silkspan...but, will have to get one of the little irons..Strictly for box repair....

---

KOLLEKTOR KOMMENTS-KONT'D (from pg. 1)

A couple of exciting items came to hand just before press-time and I thought you would like to hear about them. First, thanks to Earl VanGorder's article in FM, I sent off for a copy of the 30" ws FW-198 plan from John P. Ricci, 1230 W. Church Rd., Morrice, MI. 48857 for \$6.00 and it is a stunner! Huge plan plus John provides printwood patterns and a small 3-view with description. This is NOT the FW-189, but a twin-boom pusher Megow huge plan. It is great! Lastly, heard from AIR CORPS ACE Model Co., P.O. Box 6367, Fullerton, CA. 92634-6367 introducing their new P-26 kit with cast metal radial engine, cowl ring, engine cover, and landing gear. It will be a jewel if it looks like their first four huge solid kits! Until next time, Happy Holidays!! Lou



SOLID MODEL KIT PRODUCERS OF THE THIRTIES

by Walt Winicki

In my early recollection about 1934, I become interested with the building of model airplanes. Stimulated by the intense aviation activity, I lived just four miles south east of Mitchel and the famous Roosevelt Fields.

I remember a three view outline from a Aero Digest magazine of a Luscombe Phantom. I built this model followed by the famous Stearman Trainer and a few others. these were made out of hard wood, shaped with a draw knife and using finishing nails for cabane and inter-plane struts.

A new kid on the block moved in. He commented that you could buy these in a kit. I didn't know what he meant when he said a a kit. So, we went to his house and he showed me the display of his many solid balsa models. I was amazed! this was about 1937 and that was my introduction to model airplane kits, and then the romance began.

In May of 1990, I went through my collection of early Model Airplane News and Flying Aces magazine. Its interesting to note the many companys that feature solid model kits.

Companys	Type of solids	Reference
Scientific. N.J.	10" W.S.	M.A.N. 3/33
McCoy N.J.	14" W.S.	M.A.N. 3/33
Guillows' Mass	6" W.S.	M.A.N. 3/33
Universal Brooklyn N.Y.	6", 8" W.S.	M.A.N. 11/33
Hawk Chicago Ill.	6" W.S.	M.A.N. 1/33
U.S. Model Aircraft Co. Brooklyn N.Y.	7" W.S.	M.A.N. 1/33
Megow Phila. Pa.	6" W.S.	M.A.N. 4/33
Trost Chicago, Ill.	7" W.S.	M.A.N. 12/33
Constructo-O-Plane Brooklyn, N.Y.	6" W.S.	M.A.N. 11/34
Comet , Chicago, Ill.	8" W.S.	M.A.N. 7/34
Aircraft Chicago, ILL.	¼" inch to the Ft.	M.A.N. 7/34
PGH, Pittsburgh, PA.	11 7/8 W.S.	M.A.N. 7/34
Model Airplane supply ILL.	7½", 13" W.S.	M.A.N. 7/34
Tropical Miami Fla.	8", 9" W.S.	M.A.N. 4/34
G.H.Q. N.Y., N.Y.	6", 8" W.S.	M.A.N. 4/34
Christie Batlas Morgan Town West Va.	finished solids. 6½", 16" W.S.	M.A.N. 7/34
National. N.Y.	¼" scale	M.A.N. 7/34
Paul Jones. Ind.	6" W.S.	M.A.N. 6/34
Lawerence Chicago, ILL.	¼" deluxe solid scale	M.A.N. 5/34
Allentown. Pa.	6" W.S.	M.A.N. 5/34
Heathe. Brooklyn N.Y.	6" W.S.	M.A.N. 5/34
Presque Isle. PA.	¼" scale	M.A.N. 6/34
Continential. Brooklyn, N.Y.	8" W.S.	F.A. 6/36
Alpine model co. Brooklyn N.Y.	6", 8" W.S.	M.A.N. 12/34
Langley. Brooklyn, N.Y.	6" W.S.	M.A.N. 5/34
Aircraft model Co. Ct.	8" W.S.	M.A.N. 7/34
Lewis Models. Ill.	10½", 20½" scale	F.A. 11/35
Lt. Perry Powers. Ct.	12" W.S.	M.A.N. 8/34

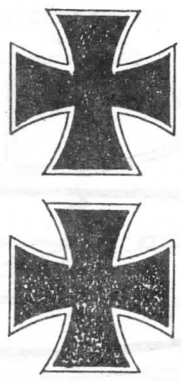

BAMBOO STRUTS

ELEVATORS

STABILIZER

BALSA AXLE FAIRING

AILERONS, ELEVATORS ETC,  
SANDPAPER WITH PENCIL BORN STRES

WING INSIGNIA  
CUT OUT AND CEMENT IN PLACE

COLOR SCHEME

FUSELAGE & FIN - ORANGE  
RUDDER & WHEEL CENTERS - WHITE  
WINGS, ELEVATORS & STRUTS - GREEN  
TRIMMINGS - BLACK  
NOTE - ONLY ONE COLOR IS SUPPLIED WITH KIT

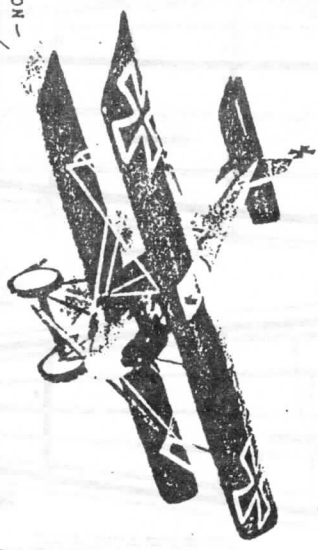

FUSELAGE SECTIONS

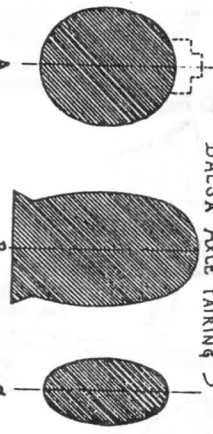

CONSTRUCTION NOTES

1. Trace side view of fuselage onto block in the kit. Cut out shape. Do the same for top. Shape fuselage to proper sections, checking with the plan. Finish off with fine sandpaper.
2. Cut out printed parts carefully, letting outlines show. Shape the wings down to the proper airfoil section, then finish off the edges. Tail parts are made in same manner. Sand all parts so as to insure a good finish.
3. Form all other parts, such as landing gear, struts, etc., that are shown on plan. Be sure all parts fit.
4. It is best to paint the parts separately before assembling. Sand after each coat is dry, to give a better finish. Parts may now be put together. Add all remaining details, as called for on plan.

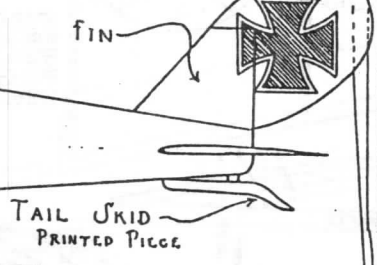

FIN  
TAIL SKID  
PRINTED PIECE

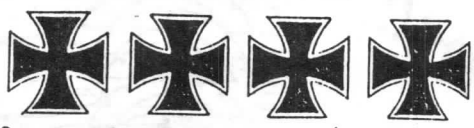

CUT OUT AND CEMENT ON FUSELAGE AND RUDDER

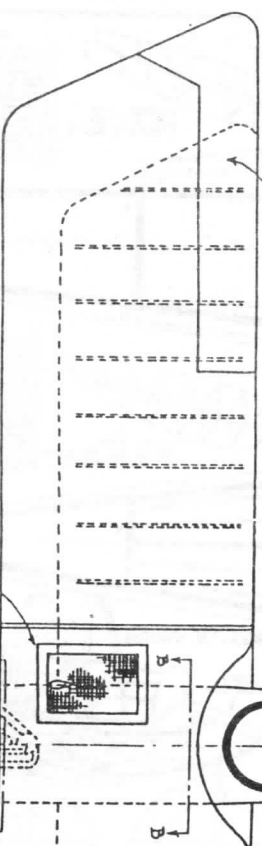

RADIATOR  
CUT OUT AND CEMENT IN PLACE

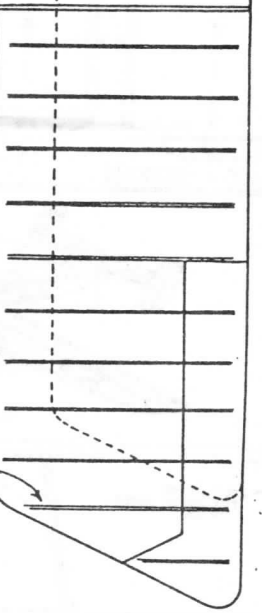

WING RIBS  
INDICATED BY THIN STRIPS OF PAPER

Pfalz D III

PROPELLER  
PRINTED PIECE

ANGLE OF INCIDENCE

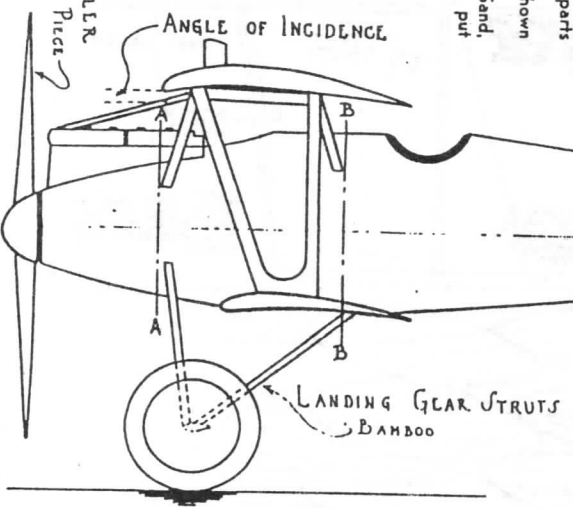

LANDING GEAR STRUTS  
BAMBOO

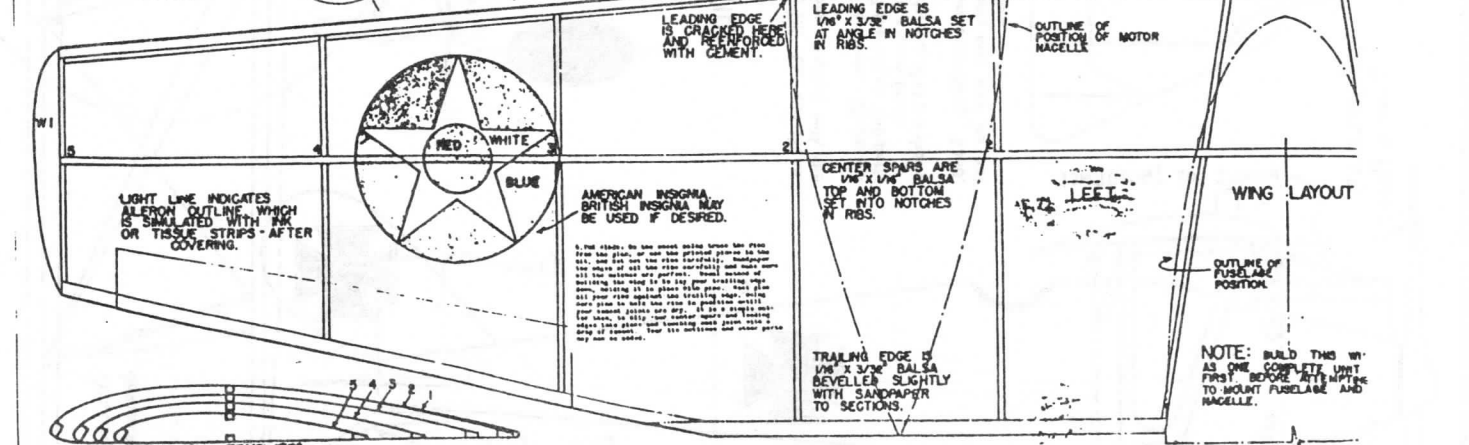
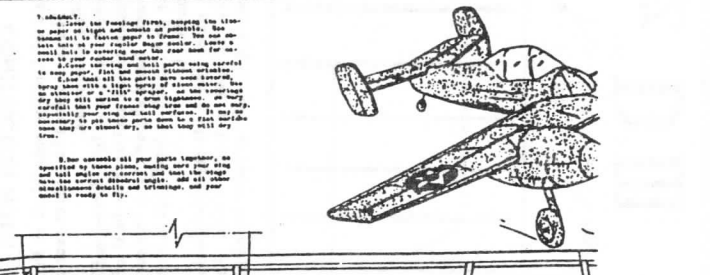
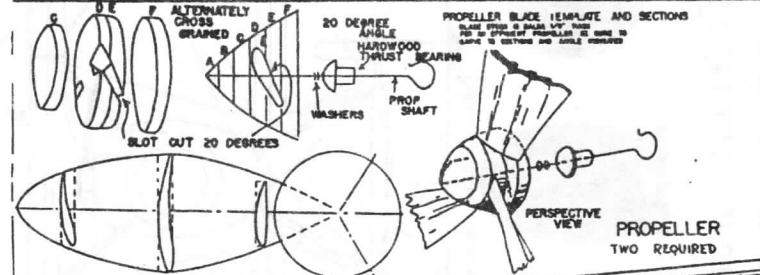
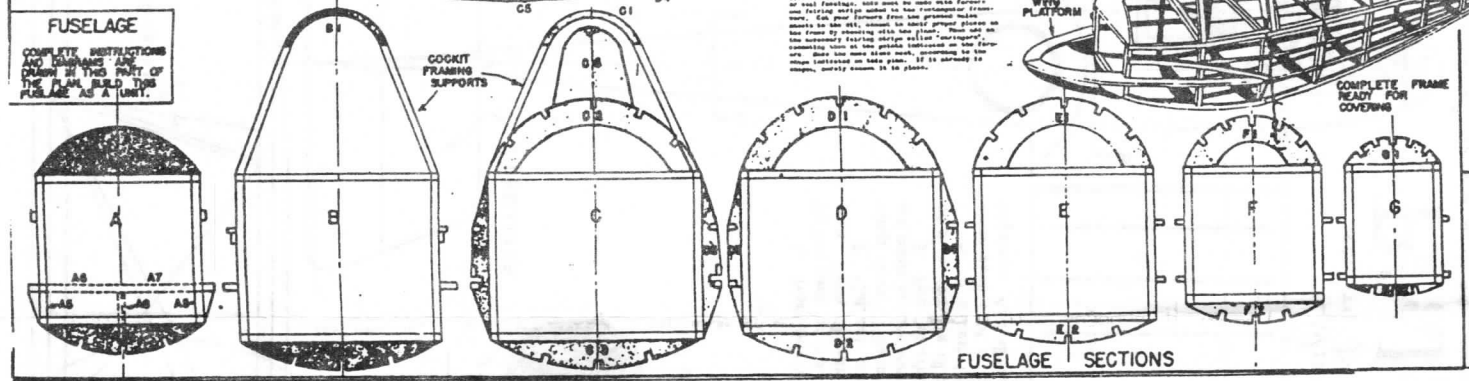
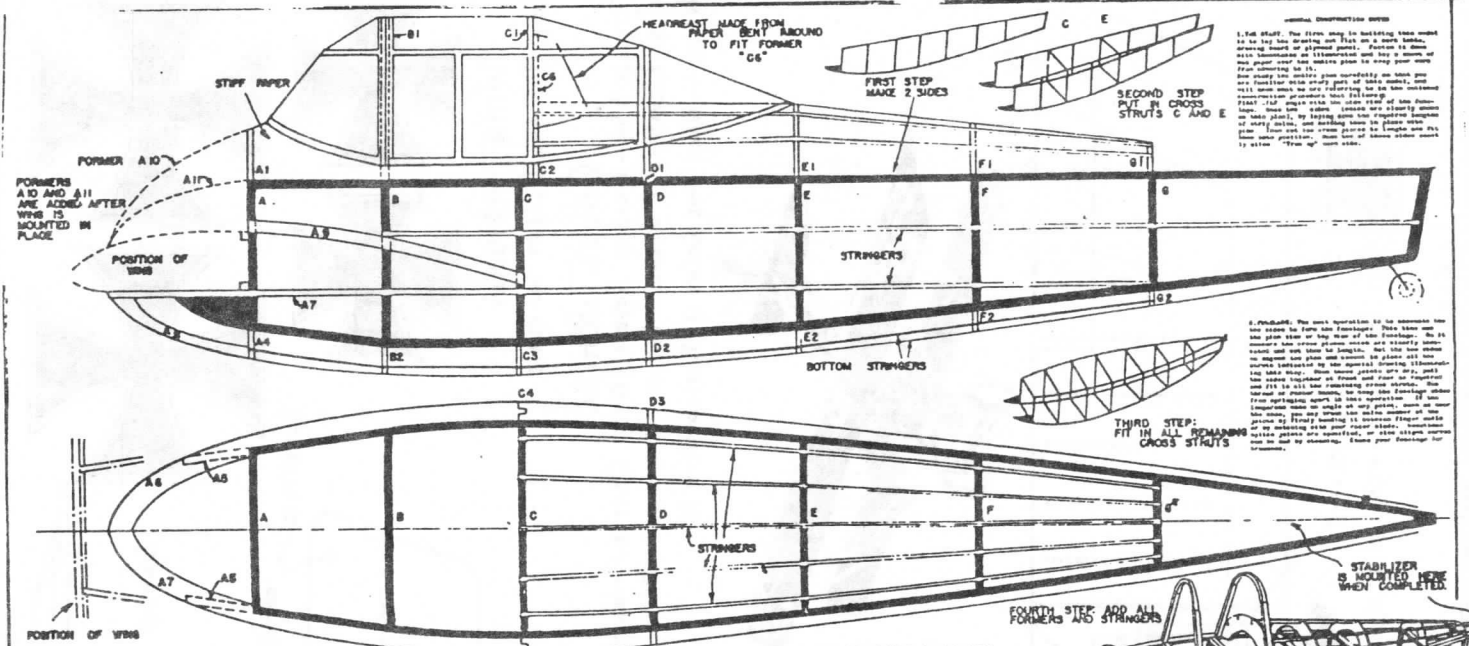

MERRY CHRISTMAS!!

6

LOW



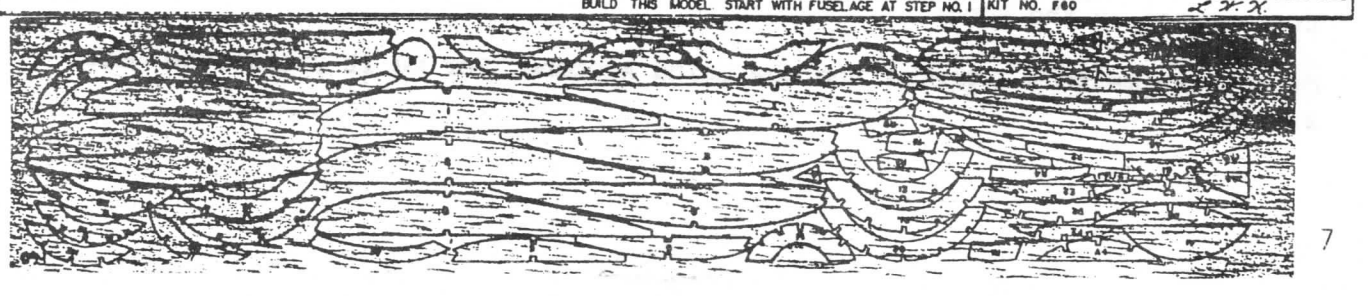
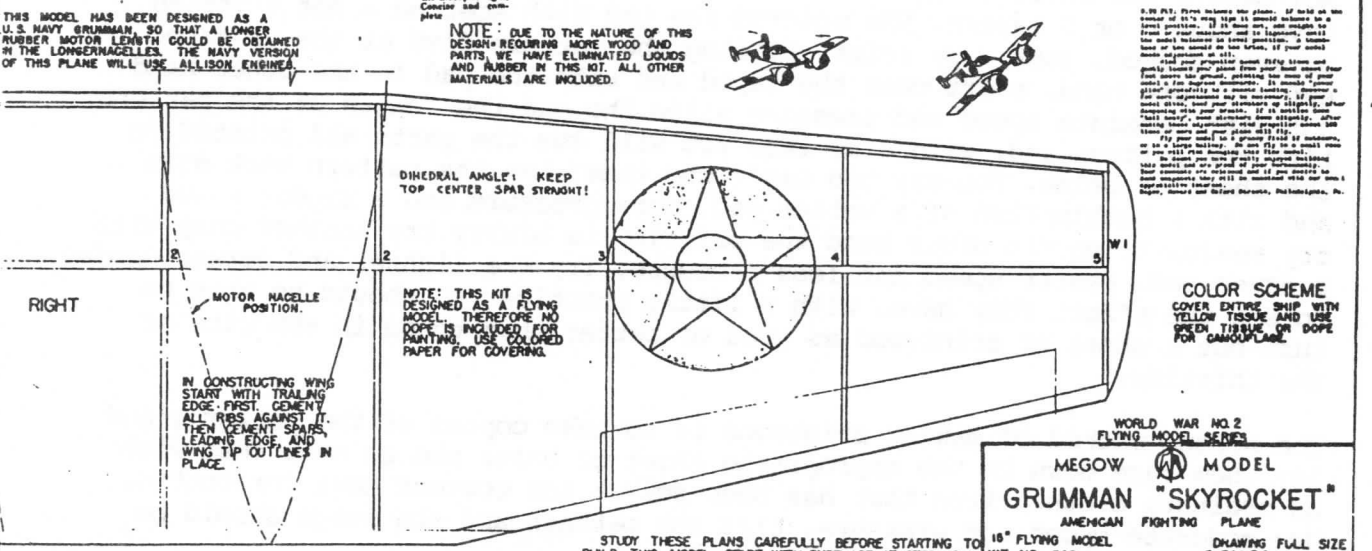
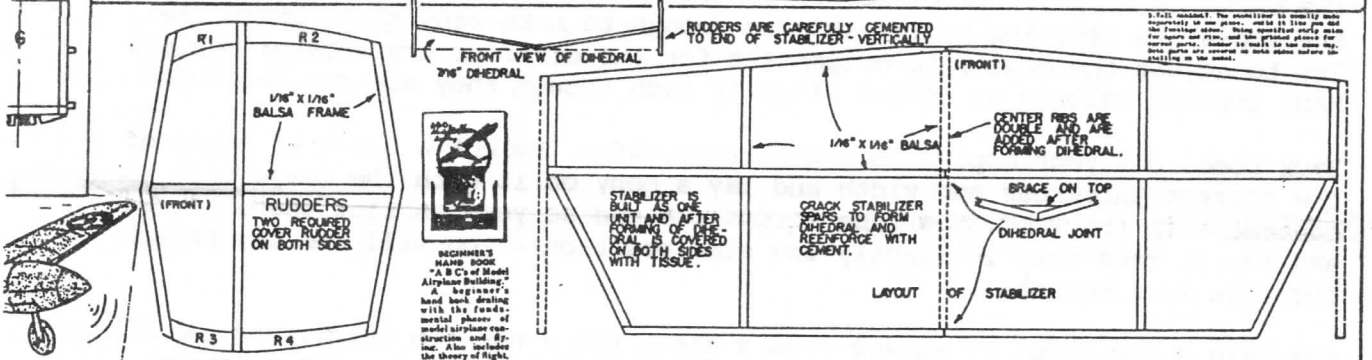
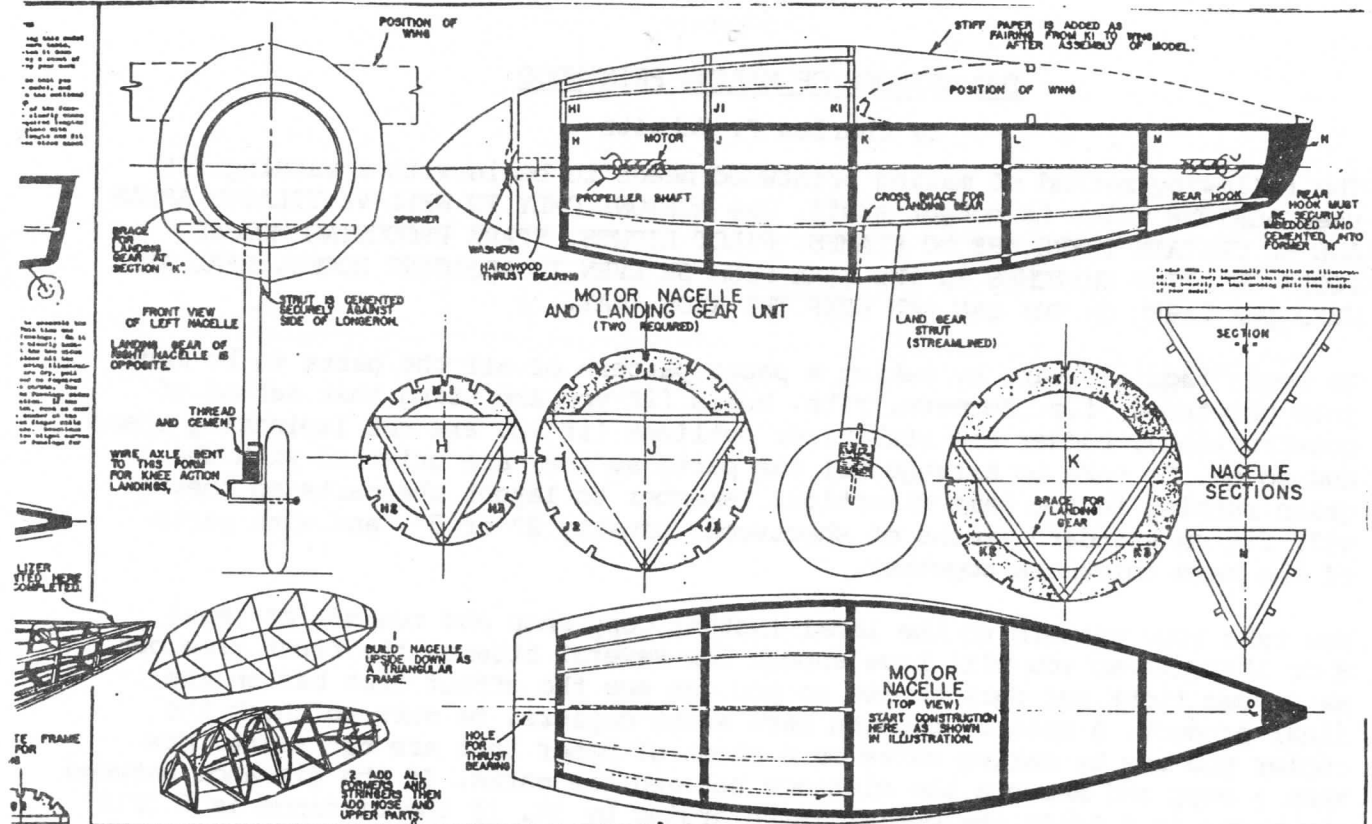



## TWO METHODS OF MAKING PRINTWOOD

by Charles F. Schultz

The following method of making printwood needs to begin with a warning. It uses ACETONE which is potent stuff. Use ACETONE ONLY IN WELL VENTILATED AREAS AND BE CERTAIN THERE ARE NO FLAMES, PILOT LIGHTS, SPARK PRODUCING MOTORS, TOOLS OR LIGHT SWITCHES IN THE SAME ROOM OR EVEN IN ADJACENT ROOMS. READ AND HEED THE LABEL ON THE CAN AND KEEP THE KIDS AWAY.

To begin (again) start by making a paper pattern of all the parts to be made into printwood, i.e. formers, ribs, keels (if you are using that method of construction), rudder and stabilizer outlines (if you are not laminating them) and so on. Be sure to arrange all the parts so they are oriented with the grain running in the same direction. Remember to layout the parts so they will fit on standard widths of sheetwood, usually 2" or 3", and with parts of the same thickness together.

Now take your pattern to the local instant copy shop and run off at least 8 or 10 copies so you will have enough for several attempts the first time out. Make some light and dark copies so you can see the effect that has on the final product. A note of caution here about copiers. Be sure to check the copier you use by making marks on a sheet of paper that are  $6\frac{1}{4}$ " apart. Now make a copy and measure the distance between the marks. If the distance between the marks is  $6\frac{5}{16}$ " the copier is enlarging by 1%. If the distance is  $6\frac{3}{16}$ " the copier is reducing by 1%. This is enough to make many parts unuseable. Try to adjust the copier to compensate for the error or try another copier. Many copiers enlarge or reduce slightly even though they are set for 100%.

Back home, cut your copies to the correct width. Select a sheet of balsa of the correct thickness and width and lay a copy on it with the image side in contact with the wood. Now tape across one end so you can lift the other end and lay it back down in exactly the same position - you will see the reason for this in a moment.

Now make a pad about 3" square from a clean rag - not too thick, the pad should have about 6 or 8 layers. Now moisten the pad with Acetone - not dripping or even soaked, just very moist. Holding the pattern down at the un-taped end with one hand, start near the taped end with the pad in the other hand and with moderate speed and pressure slide the pad the length of the pattern. Lift the pattern and, with some luck you will see the parts all printed on the sheet of balsa. You say you can't see them? Lay the pattern back down and with a combination of a wetter pad, more pressure and a slower speed try again. If on the other hand the printing is blurry try another copy with a dryer pad, faster speed and less pressure. Try the lighter and darker copies to see the effect they have. With a little practice you should be able to turn out a sheet of printwood as good or better than those in the kits of the thirties.

The second method of making printwood is to take copies of the patterns and lay them face down on the appropriate sheet of balsa and go over them with an ordinary clothes iron that has been set at the correct heat for cotton. Use moderate speed and pressure. Lift the pattern and the image should be transferred to the wood.

Of the two methods I prefer the one using Acetone. For me it yields the best results.



**WANTED KITS:**  
 MIDWEST SNIFFER F.F.  
 AMER. JR. FIREBALL. HAVE  
 SOME W.W. II KITS TO  
 TRADE (J. OTT, SOLIDS,  
 MISC.) OR WILL BUY.  
 K GERARD, 438 SANTIAGO, LONG  
 BEACH CAL. 90814. (310) 4982798

**WANTED - KIT OR PLANS**  
 FOR (CONSOLIDATED, Bklyn Co. in  
 1939) JR. ENDURANCE .10¢ or  
 SR. ENDURANCE .25¢. THESE ARE  
 CABIN MODELS, THEY ARE NOT  
 THE MODEL IN "KEN SYKORA'S  
 OLDTIMER CATALOG

VASCO L FIGUEIRA  
 566 JEFFERSON STREET  
 WESTBURY, N.Y. 11590

VASCO L FIGUEIRA  
 566 JEFFERSON STREET  
 WESTBURY, N.Y. 11590

**PLANS FREAK SEEKS OTHERS!**

**BIG LIST of M.A.N., CARSTENS, HOBBY HELPERS,  
 BRITISH M.A.P.S. - MANY NO LONGER AVAILABLE**

Will lend for your research/copy use or trade. List  
 sent free upon my receipt of your list of 30 or more  
 otherwise, send \$2.00 U.S. for my list.

Lend plans on 1-for-1 basis; no charge. Lend only,  
 charge is \$1.50/plan. HONOR SYSTEM.

A. LUEHRMANN 6136 84TH AVE. NEW CARROLLTON, MD.  
 KAPA 05T 20784

REBUILDING CRASHED 4K REPLICA OF 1936 DENNY PLANE  
 JR. GASSIE. NEED EXCELLENT PHOTOCOPY OF ORIGINAL  
 1936 DENNY PLANS (NOT 1938 REVISION) AS I  
 WANT TO MAKE PLANE LOOK AS MUCH AS POSSIBLE  
 LIKE ORIGINAL DENNY (DECO, ETC.) ANY INFO.  
 ADDITIONAL TO THAT IN 1936-37 MAGS WELCOME.  
 ALREADY HAVE MINT 4K KIT AND PLANS. THE  
 DENNY APPEARS TO HAVE BEEN THE SECOND  
 COMMERCIALY AVAILABLE US GASSIE KIT AFTER  
 THE LOUREL SPORTSTER BY SHERESHAW (COMMENTS?)  
 ALSO SEEK CLEVELAND KIT SF22 SPARROWHAWK,  
 AND CLEVELAND SF "SILVER" KITS FROM 1930S.  
 R. WILKINSON, 228 NINTH ST., N.E., WASHINGTON  
 D.C. 20002

**WANTED - GULLOW 18" WW-1 KITS**

ALBATROS D5A \*WW-1, SOPWITH SNIPE \*WW-10  
 BRISTOL BULLET \*WW-7, PFAIZ D-3 \*WW-11  
 NIEUPORT-27 \*WW-8

WILL TRADE OR PURCHASE

C.P. CHAPMAN

2628 N. CENTRAL PARK

CHICAGO ILL 60647

312-235-2697

A LITTLE BIT OF EVERYTHING:

BERKELEY, CLEVELAND, STERLING

MEGOW, JOE OTT AND FOREIGN,

SASE FOR LIST.

TRADE (PREFERRED) FOR STROMBECKER

AIRCRAFT AND OTHER MILITARY

HARDWARE. ALSO AIRCRAFT TRADING

CARDS. CLIF CARLSON 1511 POSEY AVE

ALBANY CA 94706 (510) 524-1079

**WANT: RANGLES SIKORSKY R-4, HILLER COPTER  
 KELLET AUTOGyro, FACTORY BUILT WOOD  
 H-19 (S-55) GIVEN OUT BY SIKORSKY IN THE 50's -  
 ANY MARKINGS - ANY CONDITION, ANY HELICOPTER,  
 AUTOGYRO MODELS, PLANS, BOOKS, PHOTOS,  
 ANY ISSUES OF AMERICAN HELICOPTER MAGAZINE  
 1945-1960, R. DELALIO, 510 MILLIGAN LA,  
 WEST ISLIP, NY 11795**

**WANTED:**

COPIES OF PRINTWOOD FOR  
 COMET KIT (1940) OF CURTS P-37  
 30" WINGSPAN. KIT # L-7. NAME PRICE.

REPLY TO:

C.D. BARKER

2418 LYNN ST.

ANDERSON, IND., 46016

**WANTED: PLANS FOR EAGLE CONTROL LINE**

66F HELLCAT VINTAGE 1945-46.

-ALSO -  
 ANY PLANS, PICTURES, ETC. FOR 1937

ITALIAN "MAGNI VALE". EXCEPT LINDBERG RUBBER  
 PLAN. JAMES W. KIRK, 15750 CHANDELLE PL,  
 WEST PALM BEACH, FL. 33414.

Buy/SELL/TRADE: WOOD A/C KITS. INCLUDES  
 MONO 5/8 & 3/8. ALSO BY STROMBECKER, A/C,  
 SHIPS, TRAINS, ARMOR. MOST WANTED KITS,  
 MAIRCRAFT DC3/C47, DYNAMODEL P-38, F82  
 BURKARD STM2, STUKA, CORSAIR. ED  
 MARCINIEC, 25 LORI ST, SPOTSWOOD, N.J. 08884

MERRY CHRISTMAS KAPA!!

WANTED: PHOTOS AND/OR 3 VIEWS OF AMELIA EARHART'S LOCKHEED ELECTRA 10E. MUST SHOW BOTH PORT AND STARBOARD SIDES OF CHANGES MADE TO STANDARD AIRCRAFT AND THE LOCKHEED LOGO IN USE AT THAT TIME.

ALSO: PHOTOCOPIES OF THE PLANS AND ARTICLE [BOOK MAYBE] ON THE WESTLAND WAGTAIL AS PUBLISHED IN THE BOOK OF WESTLAND AIRCRAFT BY HARBOROUGH IN ENGLAND.

SAMUEL C. MORGAN 715 COLBERT AVE. #1 PENSACOLA, FL 32507

Need Original Plan for BERKELEY 54" COMMANCHE #3-9.... Want JIM WALKER XP PURSUIT; JIM WALKER COAST GUARD GLIDER and JIM WALKER B-10 BOMBER.... Want 1930s issues of M.A.N.; Have back issues of MODEL BUILDER to trade.... Want MONOGRAM SUPERKITS.. MONOGRAM SPEEDEE BILT KITS, GENE THOMAS CLASSIC MODELS 13" PEANUT KITS, MOREHOUSE 13" PEANUT KITS.... Need box for COMET SEVERSKY PURSUIT #E-20.... Need box for COMET VOUGHT PURSUIT #A-5.... Have JOE OTT empty box #4004 and CLEVELAND IT PIPER empty box to trade.... Also have MAIRCRAFT #H-8 DOUGLAS DAUNTLESS, MAIRCRAFT #5-7 GLOBE SWIFT SOLID, JIM WALKER FIREBABY JR., JASCO FLEET (6 for 69 cents HLG KIT), SCIENTIFIC "THE SEA WITCH" CLIPPER SHIP (kit has been started).... Will trade for small MEGOW, COMET, AMCO SOLIDS and for S & T kits....Thanks.... Welcome to KAPA. CHARLIE T. GLASSIE, JR., 4622 N. 13th St., Tacoma, WA 98406

For Trade: Reproductions of Modern Hobbycraft Plans of WWII aircraft, all printed in 1943. Very nice single sheet plans for solid wood models, also a few large gas models. The latter are configured for CL but could be adapted to RC. Send SASE for list, let me know what you have to trade (interested in all kinds of early plans).  
Wanted to buy: Series 100 Guillow's kits, or at least copies of plans; solid WWI and Golden Age kits; WWII Victory ship / APA.

Eric R. Craine, 4681 N. Cerritos Drive,  
Tucson, AZ 85745 602-325-4505 (days)

WANTED: Veron Viscount kit, also Frog flying kits and Top Flite Taurus and Orion. Alan Simpson, 124 Walthen Dr., Charlottetown, P.E.I., Canada. CIA 4V5.

SELL: Many Aviation and Military books. Some about WWI. Send legal size SASE with 75¢ postage. Don Waters, 1529 Oakwood Dr., Norman, OK 73069

WANT: These two solid wood kits from my childhood in early 50's. Strombecker C-33 P-61C Black Widow & Comet ? submarine U.S.S. Perch. Condition not as important as price. I want them for sentimental reasons only. Michael Sullivan 4154 Burma Rd. Mobile, AL 36693

WANTED: Scientific, Kellett U/C Autogiro kit, plans or completed model. Also wanted-Berkeley Cloud-Copter "D" or Cloud-Copter "TR" kit, plans or completed model or any autogiro kits, plans or models. Ed Jones, 10405 Button Quail Dr. Austin, TX 78758-5032

GEORGE S. TALAS 3835 COVINGTON ROAD, SOUTH EUCLID, OHIO 44121

WANTED: PEERLESS MODEL AIRPLANE CO. KITS

1/2" Scale Curtiss Army Hawk #6-E

1/2" Scale Lockheed Vega

1/2" Scale U.S. Army P-26 Peashooter

ALSO: TOMASCO KIT : Boeing F4U (P-12) Navy Fighter Scale

If not willing to sell will accept xerox copies of all printwood patterns and insignia sheets (I have the plans) Will pay \$20.00 per kit including S&H charges for the xerox copies.

WANTED: Info on old catapult jets (Rictor?) and Skyleada plans by Ray or Roy Booth in England. Looking for kits or plans. Jetex Forever! Roger Wathen, 3242 N. DeQuincy St. Indpls., IND. 46218.

While they last - TRAVEL AIR 4000 BIPLANE balsa solid model kits, 1930s style, complete with cast-metal radial engine and prop, hardwood wheels, 2-color decals and detailed plans. \$9.95 each plus \$2.50 P&H.(Limit 2)

ILLUSTRATED CATALOG OF MODEL & FULL-SIZE AIRCRAFT PUBLICATIONS! Gee Bees, Peanut Power, Stick & Tissue, Models & Musings, Aviation Postcards and all of Frank Zaic's publications. Send \$1 (refundable).

Send SASE for miscellaneous aviation books and back issue model airplane magazines lists. HANNAN'S RUNWAY, Box 210, Magalia, CA 95954.

\*\*\*\*\*

WANT: PLAN OR COPY OF PLAN FOR FLYING CLOUD BY DOUGLAS MOD AIRCR CO, SEATTLE. RUB PWD CABIN ENDURANCE (1930'S). NOT THE STRUCK/BERKELEY KIT. MAY BE ANY CONDITION, SIZE, CAN COPY & RETURN. SEND POSTCARD. PAUL McILRATH

\*\*\*\*\*  
1524 48 ST NE, CEDAR RAPIDS, IOWA 52402  
\*\*\*\*\*

# WANTED

PLAN OR KIT OF EASY BUILT  
FLEET CANUCK 20" SPAN

(NOT THE FLOAT VERSION STILL AVAILABLE)

ALSO

COLOR PHOTO COPIES OF BOX ART  
OF E-SERIES COMET KITS OF THE 50'S

WENDELL HUGHES

RR 2 MORELL

PRINCE EDWARD ISLAND

CANADA COA 150

902-961 2846 PHONE

WANTED: Kits or plans and printwood for the following:

1. Battaglia Model Airplane Co. Dewoitine D-500, 30" ws
2. Crescent Model Aircraft Curtiss A-8
3. Universal Model Airplanes Curtiss-Wright Junior
4. Ripin Model Airplane Co. Curtiss F9C2
5. Selley Manufacturing Co. Curtiss Falcon
6. Scientific 1/2A Piper Tri-Pacer kit
7. Gullwings Pfalz D.III kit
8. Miniature, Burkhard, Cleveland, Berkeley, Sterling, Consolidated, and other old-time balsa scale kits.

FOR SALE OR TRADE FOR ABOVE:

1. Scientific 1/2A Piper Super Cruiser
  2. Scientific Nautilus Submarine balsa kit
  3. Comet P-61 Black Widow solid balsa kit
  4. Cleveland printwood for SF 2D and SF 105
- Lou Buffardi, 400 Windward Passage, Slidell, LA. 70458

For TRADE Only!

Monogram Speede-Bilt Kit # H-1

B-25 Mitchell - Date on plans 1953

Box and kit in excellent condition.

Will trade for Monogram Speede-Bilt

P-47 Thunderbolt.

Contact: Paul H. Comeau

P.O. Box 1363

Leominster, MA. 01453

Phone (508) 534-8981

F O R S A L E \*\*KITS\*\*EASY BILT "WRIGHT  
FLYER I-1903", 24"-\$10; COMET KIT #3505  
"TAYLORCRAFT"-\$10; MIDWEST "GOLLYWOCK" (PARTS  
CUT OUT)-\$20; JACK ARMSTRONG CARD MODELS, P-  
47, P-40, AND ZERO-ALL \$5\*\*PLANS\*\*EARL STAHL'S  
SEMI SCALE "DEFIANT" 36" RUBBER-\$3; COMET  
"BOULTON PAUL DEFIANT" 25" RUBBER FROM 1940-  
\$3; STAHL'S "FAIRCHILD 24", 29" RUBBER-M.A.N.  
1940-\$3; BERKELEY "BOOTSTRAPS A-R/C" FROM  
1952-\$5; "SWOOSIE" R/C FLOAT PLANE FROM 1992-\$5  
W A N T E D PRE 1942, RUBBER POWERED, SCALE  
KITS(EXCEPT CLEVELAND)\*\*ALSO WANTED\*\*\*ACE  
WHITMAN "BOULTON PAUL DEFIANT" KIT. 36" W/S-  
RUBBER

MORRIE LEVENTHAL-1788 NIOBE AVENUE  
ANAHEIM, CA 92804 (714) 535-6570

WANTED: Gullow's Fieseler Storch Kit #304; 100-series  
WW-I kits; DeHavilland 4 Kit #205 and Rumpier C-5 Kit  
#206; DeHavilland Mosquito Mk-IV Kit #804; Bell P-39D  
Airacobra Kit #806. Also Want Sterling Ansaldo SVA5 Kit  
#A-18; SPAD XIII Kit # A-21, or any discontinued Sterling  
or "old time" World War I or II "stick and tissue" free-  
flight scale kits from the past. Builder/Collector will  
pay top prices. George J. Santikian, 7285 N. Channing  
Ave., Fresno, CA. 93711. (209) 439-3363.

FOR TRADE:

JOE OTT DeHavilland Mosquito (1944)

3/4"-1', 40 5/8" span, complete, box rough

ACE WHITMAN Ju87B Stuka, #2946, (1941)

5/8"-1', 28" span, complete, box rough

KEIL KRAFT Luscombe Silvaire (1951) 40", as new

FOR SALE:

JOE OTT Curtiss P-40, 27" span

incomplete but usable, box rough, \$15

MARK BRAUNLICH, 38628 Ninadell Ave.

Willoughby, OH 44094

A collector has asked me to  
dispose of his collection for  
him. These are original K&B  
and Aurora and other 1/4"  
scale plastic kits in boxes.  
Send SASE for list. Lou Buff-  
ardi, 400 Windward Passage,  
Slidell, LA. 70458

PLAN - SIKORSKY R-6 - COMET No. E9  
FOUR 8x11 SHTS. FLAT #2 SO ALL FEES IN-  
CLUDED. STAMPS ACCEPTED. RICHARD MILLER  
134 DAKOTA #113 SANTA CRUZ, CA 95060



**KITS AND PLANS ANTIQUITOUS ("KAPA") INFORMATION**

Kits and Plans Antiquitous ("KAPA") is a club for modelers who enjoy collecting, preserving, restoring, and exchanging wood model airplane kits and plans which are no longer available, as well as learning more about the companies and people who originally created them, or who are re-creating them today.

KAPA annual membership is from April 1 to March 31. It includes the club's quarterly newsletter, KAPA Collector, which is published in June, September, December, and March. The Collector includes news of the club, historical information, how-to-do-it articles, plans and photos, and classified advertising which is free to members.

Members' stories or articles are solicited for publication in the Collector. If possible, the text and any illustrations should be submitted ready for publication. See articles already published in the Collector for guidance on content and style.

Advertising in KAPA Collector is free to members. Send advertising (typed or neatly lettered in block letters, using black ink) on a 3 x 5 file card or a postcard to the editor. Each advertisement will be run for one month. If the same advertisement is to be run again it should be resubmitted.

In advertising or describing items for sale or trade, club members should fully describe the condition of items offered. Describe any kit box wear, damage, or repairs and any known parts missing or not original. Plans should be stated to be originals, photocopies, blue line prints, etc.. If shipping charges are extra they should be specified.

Advertising or editorial material must reach the editor, Louis N. Buffardi, 400 Windward Passage, Slidell, LA 70458, by the 15th of the preceding month for each issue: May 15, August 15, November 15, February 15.

Membership dues are \$6 per year in the U.S. (\$8 in Canada and Mexico, \$11 via air mail in other countries, all payable in U.S. Dollars). After September 15th, new members may pay half the regular dues and receive only the two remaining issues of that year's membership or may pay full membership and receive that year's prior issues as well. Individual back issues are available at \$2 each in the US (\$2.50 in Canada and Mexico, \$3.25 in other countries, via air mail, all payable in U.S. Dollars). Send payments to Jim Alaback, 12366 Nacido Drive, San Diego, CA 92128-3108 U.S.A.

**NOTIFY JIM ALABACK (12366 NACIDO DR, SAN DIEGO, CA 92128) OF ANY CHANGE OF ADDRESS.**



Louis N. Buffardi  
400 Windward Passage  
Slidell, LA 70458

**FIRST CLASS MAIL**



TO:

100-F 3/94  
Claude H. Powell  
P.O. Box 454  
Ridge, MD 20680

20680-0454

